

PLAN
Scale 1" = 40'

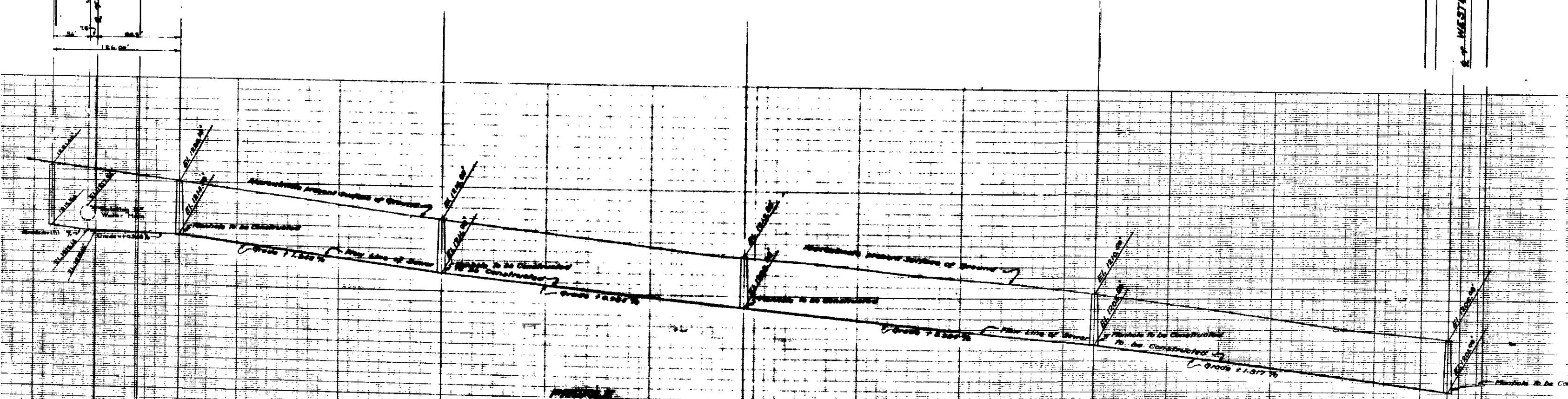

PROFILE
Scale (vert.) 1" = 4'
Scale (horiz.) 1" = 40'

NOTE
All Manhole Pipe, Catching Basins shall be constructed with a leaded grade of two feet from the Main Sewer and shall extend from the Main Sewer to the Property Line.

PROFILE LEGEND
Approximate Present Surface of Ground
Shown by Black Line Thus: ———
Flow Line of Sewer to be Constructed
Shown by Red Line Thus: ———